

Roackstar
Dishwasher
instructions



Away
Resorts

Rockstar Units Dishwasher Instructions

Montpellier MDI450-2 Integrated Dishwasher found in Itchycoo Park 5, 9, 12, 14 and 15

Manual - <https://www.montpellier-appliances.com/media/312079/montpellier-mdi450-2-instruction-manual-021118.pdf>



- 1 - Turn on the dishwasher using the On/Off button.
- 2 - The default setting will be P4 – Eco Mode – which will be suitable for most cases.
- 3 - If you are only running a half load, press the half load button.
- 4 - To change the program, press the program button.

Programs are as follows:

Extra Hygiene	Intensive	Super 50' 65°C	Eco (reference)	Quick	Prewash
70°C (P1)	65°C (P2)	65°C (P3)	50°C (P4)	40°C (P5)	- (P6)

5 – Insert detergent powder or tablet as shown below.

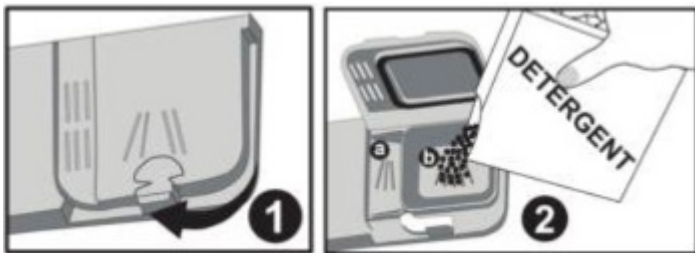

6 – Follow the loading instructions.

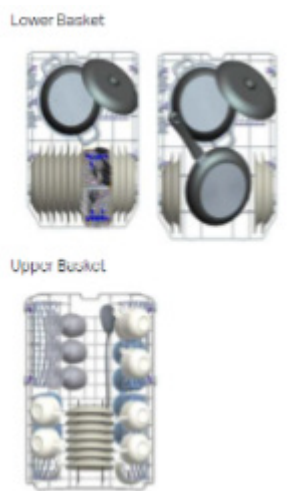

Ensure any sharp items such as knives are loaded into the cutlery basket pointing down to avoid injury.

7 – Close the door and wait for the cycle to start.

8 – Do not open the door while the cycle is in process.

If the Rinse Aid, Salt Indicator, Error Codes or Infall Warning Light is on please contact Guest Services.

FocalPoint Dishwasher found in Itchycoo Park 13, 10, 6, 8, 2, 1



1. Power indicator: To show when the power on.
2. Salt and rinse aid warning lights: To show when the salt container or dispenser need to be refilled
3. Delay indicators: to show the delay time (3h/6h/9h/)
4. Haft load indicator : To show when you select the haft load function .
5. Program indicators: to show which program you have chose;
6. Half load functions Button: To select Half load functions. (With this Half load function you can only use it when you have only about or less than 5 place setting dish wave, and you will see less water and energy consumption , can only be used with Intensive, Normal, ECO, Glass and 1 Hour .)
7. Delay Button : To Press the button to delay.
8. Program Button : To Press the button to select a wash Program.
9. On/Off Button: To turn on/off the power supply.

- 1 – Turn on the dishwasher using the On/Off button.
- 2 – The default setting will be Eco Mode – which will be suitable for most cases.
- 3 – If you are only running a half load, press the Half load button.
- 4 – To change the program, press the program button.

Programs are as follows:

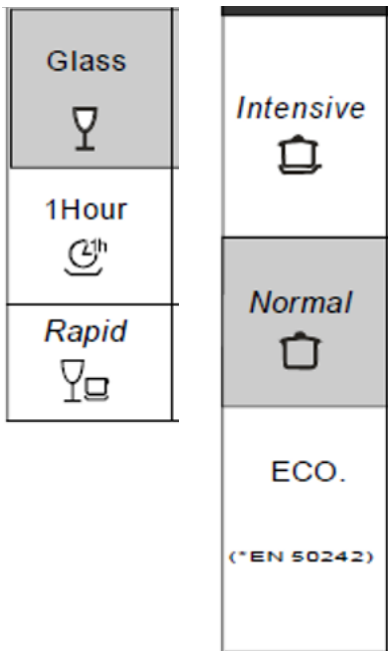

5 – Insert detergent powder or tablet as shown below.

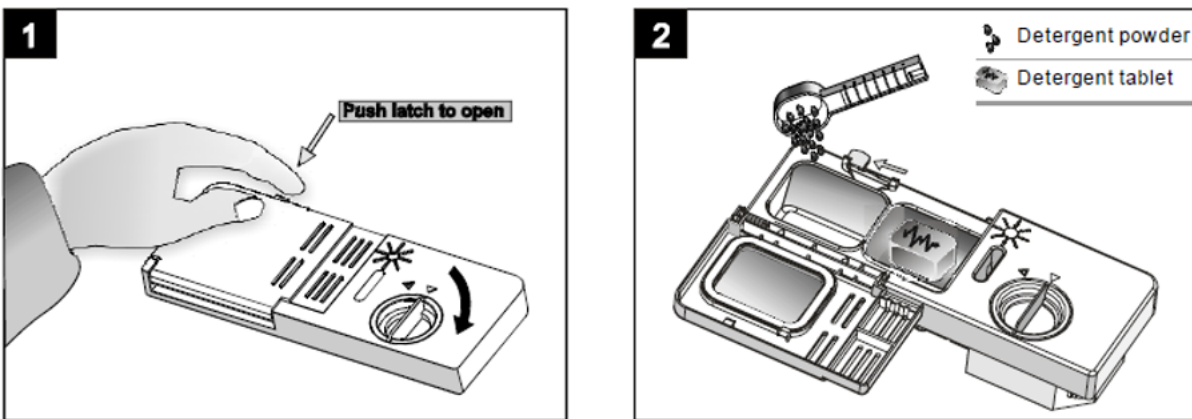

6 – Follow the loading instructions.

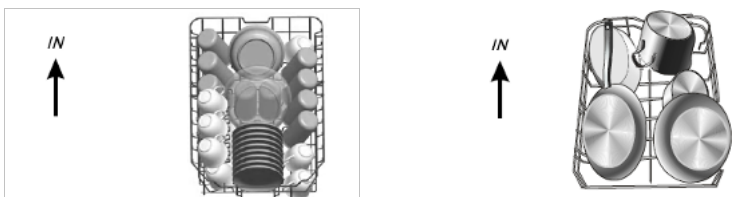

Ensure any sharp items such as knives are loaded into the cutlery basket pointing down to avoid injury.

7 – Close the door and wait for the cycle to start.

8 – Do not open the door while the cycle is in process.

If the Rinse Aid, Salt Indicator, Error Codes or Infall Warning Light is on please contact Guest Services.

Currys Essential Integrated Dishwasher found in Itchycoo Park 4, 7, 11

Product Code – CID5B16/A

Manual - <https://manuall.co.uk/currys-essentials-cid45b16a-dishwasher/>



- 1 – Turn on the dishwasher using the On/Off button.
- 2 – The default setting will be P3 – Eco Mode – which will be suitable for most cases.
- 3 – If you are only running a half load, press the half load button.
- 4 – To change the program, press the program button.

Programs are as follows:

Programme	ECO* (EN50242)	Rapid
Intensive 		
Normal 	90-min 	

5 – Insert detergent powder or tablet as shown below.

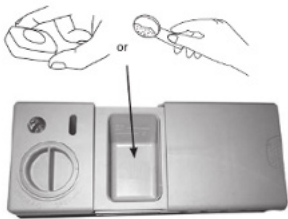

7 – Follow the loading instructions.

Ensure any sharp items such as knives are loaded into the cutlery basket pointing down to avoid injury.

8 – Close the door and wait for the cycle to start.

9 – Do not open the door while the cycle is in process.

If the Rinse Aid, Salt Indicator, Error Codes or Infall Warning Light is on please contact Guest Services.



*Away
Resorts*